

Devenish, L.

ORES CLOSE

Undated MS but probably 1955. (*T.R. Shaw says 1957*)

C10

Rodney Pits Plantation.

During the early years the above area was levelled. No open shafts were discovered although one subsidence suggestive of some underground cavity was noticed.

Some specimens of galena ? were found – these were sent to the Geological survey representative covering the area.

Ores Close.

Extensive ~~levelling~~ bulldozing took place adjacent to the above farm.

In the corner of which E six new shafts were opened. Five of these were explored – 4 to the bottom their depths were of the order of 30'–80' one was explored for 40' became narrow, the shaft could be seen to descend further and stones dropped suggested another 40'. The sixth shaft ~~deeen~~ was not explored. But unskilled sources suggested by the dropping of stones that it was 150' & ended in water (v. likely as the nose indicated that it received considerable quantities of sewage.) No minerals of interest were observed although a piece of clay (provisionally identified as a miners tally was found and recovered.). The two known shaft were explored – the one nearest the ro^ad was found to be too dangerous to explore (despite stories of depths of 210') W.I.S. wrote a form of
in the possession of Geol Survey

report on the other shaft 7. – no trace was found of the mythical 10' band of galena. The Geol Survey collaborated.

Bracken roots were observed to be hanging to a depth estimated to be 18' in the dank air – presumably to collect moisture.

Green Ore.

of Miles Lot adjacent to Road

An area of about 4 acres / was bulldozed – two new shafts were opened. ~~Neither exceed 100' one was~~ One was explored to bottom at 100' the other was explored to 70' when it became too dangerous – subsequent plumbing operations could get no re^ading over 100' No minerals were observed. Two nests of adders were destroyed one containing two adults about 3' length & several young (about 5). U.B.S.S. did explorations.

L.D.

(Handwritten MS, stapled with brown card cover, original Loaned to WCC 16/08/2003)
Verbatim transcription by PGH

ORES CLOSE

PRIMY

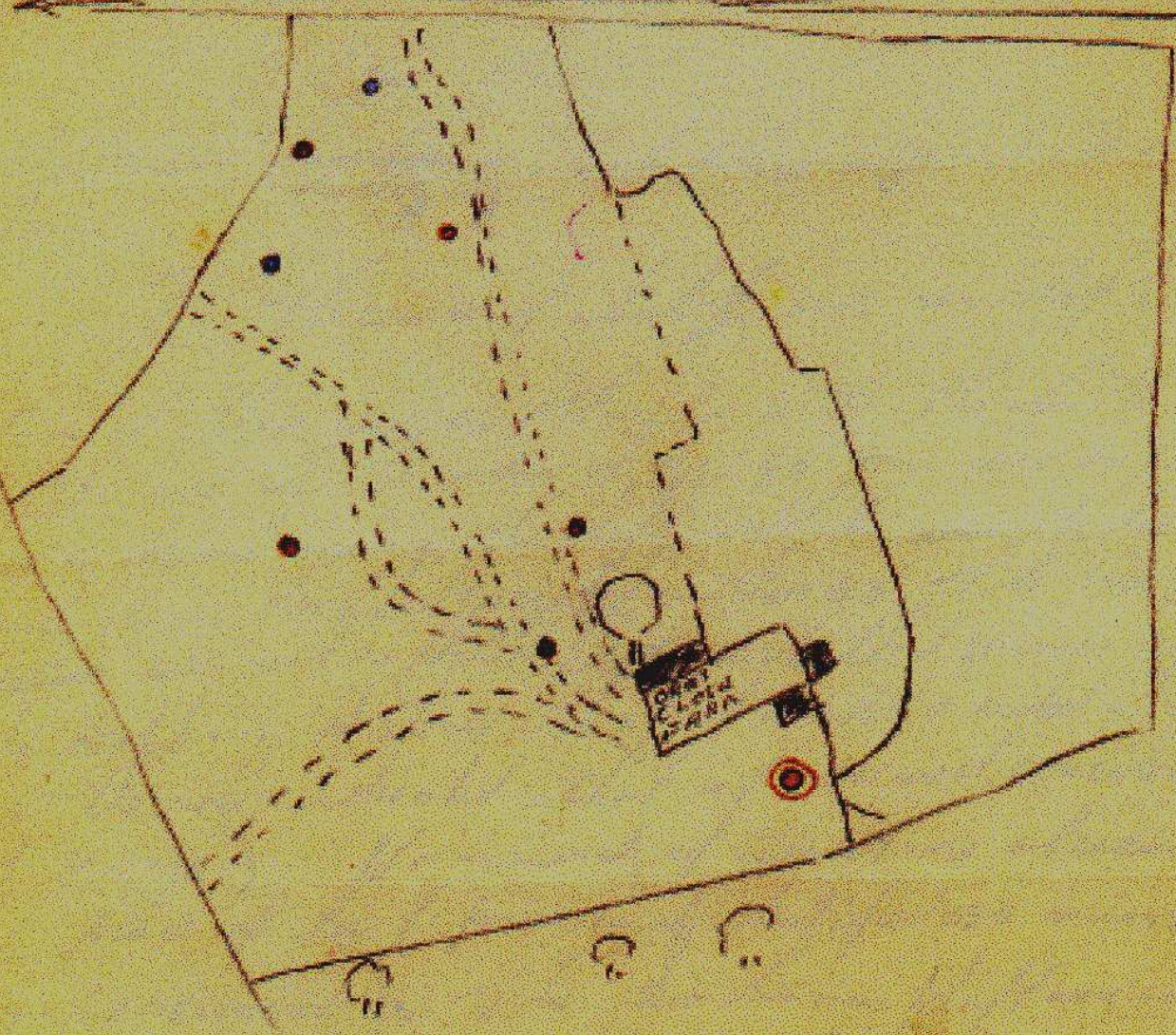

- Known shafts
- Shafts opened
- Unexplored

ORES CLOSE

PRIDY

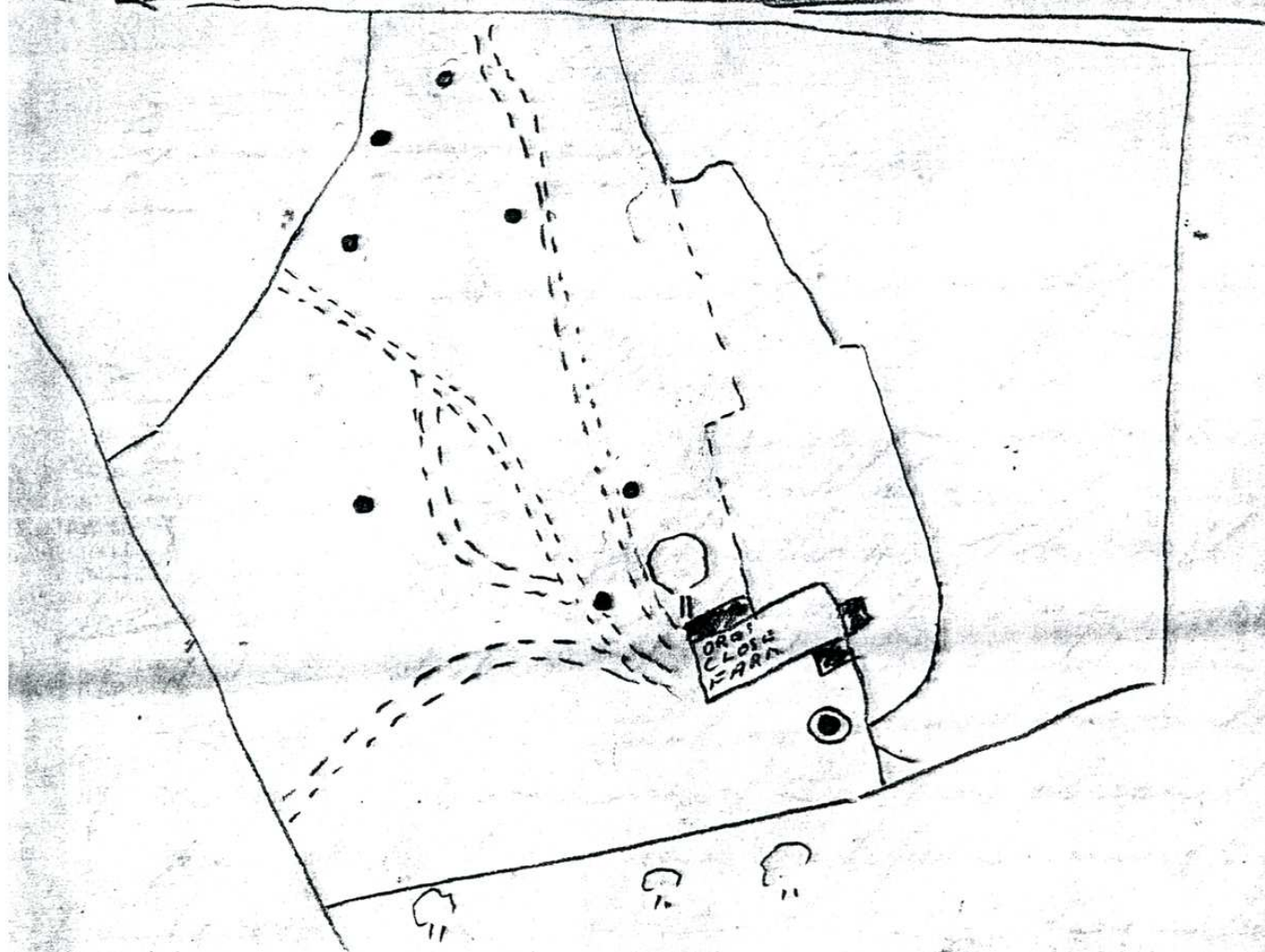

- Known shafts
- Shafts opened.
- Unexplored.